

# 5450

## STANDARD SPECIFICATIONS

### HOUSING

Cold rolled steel, die-formed assembly.

### DIFFUSER

Translucent, UV stabilized white acrylic. Diffuser has decorative grooves, sanded finish, and is formed over a mold before being bonded to a Nickel Tone frame. The diffuser also features two decorative medallions.

### ELECTRICAL

T5 Linear Fluorescent, bipin lamp (by others) – 120-277V Electronic HPF Ballast  
 T5HO Linear Fluorescent, bipin lamp (by others) – 120-277V Electronic HPF Ballast  
 T8 Linear Fluorescent, bipin lamp (by others) – 120-277V Electronic HPF Ballast

Fluorescent fixtures utilizing an occupancy sensor should include a programmed start HPF ballast. Fluorescent lamps powered by instant start or rapid start ballasts, or GU24 base compact fluorescent lamps used in this application may result in severely shortened lamp life and/or ballast damage.

### MOUNTING

Fixture uses wall anchors (by others) appropriate for the mounting surface.

### FINISH

The 5450 series has medallions available in Nickel Tone as a standard, and in select Brownlee paints as an optional offering.

PROJECT:

MODEL #:

FIXTURE TYPE:



NT finish

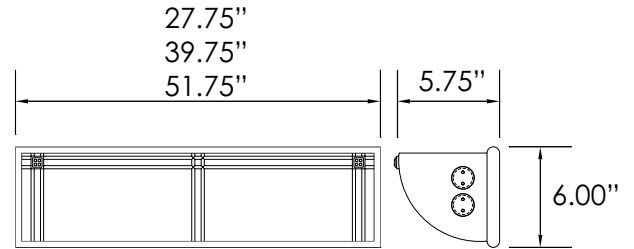

DAMP

## ORDERING INFORMATION

5450 -

Model

2.

3.

4.

5. (if required)

### 2. SIZE

**26** L: 27.75"  
**38** L: 39.75"  
**50** L: 51.75"

### 3. FINISH

**STANDARD**  
**NT** Nickel Tone

**OPTIONAL**  
**BL** Black  
**BZ** Bronze  
**GM** Gun Metal  
**MB** Metallic Bronze  
**MG** Metallic Gold  
**PL** Platinum  
**WH** White

**CUSTOM**  
 Provide color sample or RAL code to match

### 4. WATTAGE

**26 SIZE**  
**14L** 1-14W T5, elec. HPF  
**214L** 2-14W T5, elec. HPF  
**17L** 1-17W T8, elec. HPF  
**217L** 2-17W T8, elec. HPF  
**24L** 1-24W T5HO, elec. HPF  
**224L** 2-24W T5HO, elec. HPF

**38 SIZE**  
**21L** 1-21W T5, elec. HPF  
**221L** 2-21W T5, elec. HPF  
**25L** 1-25W T8, elec. HPF  
**225L** 2-25W T8, elec. HPF  
**39L** 1-39W T5HO, elec. HPF  
**239L** 2-39W T5HO, elec. HPF

**50 SIZE**  
**28L** 1-28W T5, elec. HPF  
**228L** 2-28W T5, elec. HPF  
**32L** 1-32W T8, elec. HPF  
**232L** 2-32W T8, elec. HPF  
**54L** 1-54W T5HO, elec. HPF  
**254L** 2-54W T5HO, elec. HPF

### 5. AVAILABLE OPTIONS

**BAC** Buy American Compliant  
**BBI<sup>1</sup>** Integral Battery Backup (T8 only)  
**BBIC<sup>1</sup>** Integral Battery Backup, Cold Weather (38 & 50 size, T8 only)

1) BBI & BBR options have an operating temperature of +32°F to +122°F. BBIC & BBRC options have an operating temperature of -4°F to +131°F. BBR & BBRC are field installed options available on all HPF fluorescent (CFL & T8) fixtures, except those with dimming ballasts. The maximum distance between the battery and the fixture is 10' for HPF ballasts.

### Specifications and dimensions subject to change without notice.

Consult your Brownlee Lighting representative for availability and ordering information.