

ETCH [LINEAR]

STANDARD SPECIFICATIONS

HOUSING

Cold rolled steel, die-formed assembly.

DIFFUSER

Translucent, UV stabilized white acrylic. Diffuser has decorative grooves, sanded finish, and is formed over a mold before being bonded to a Nickel Tone frame. The diffuser also features two decorative medallions.

LED PERFORMANCE - 3500K STANDARD

120-277V - 3500K, 82 CRI - L80 rating - 60,000 hrs - L70 rating (projected) - 100,000 hrs
Amperage rated @ 110V input
Operating ambient temperature: -20°C / -4°F - 40°C / 104°F

Delivered 3500K lumens noted. Consult Brownlee.com for performance of all CCTs.
H16 - 16W nominal, .14 A input - 2024 lm. Dimmable (0-10V).
H25 - 25W nominal, .20 A input - 2989 lm. Dimmable (0-10V).
H32 - 32W nominal, .26 A input - 4008 lm. Dimmable (0-10V).

MOUNTING

Fixture uses wall anchors (by others) appropriate for the mounting surface.

FINISH

The 5450 series has medallions available in Nickel Tone as a standard, and in select Brownlee paints as an optional offering.

WARRANTY

5 year limited warranty on this LED product. Consult factory for details.

PROJECT:

MODEL #:

FIXTURE TYPE:

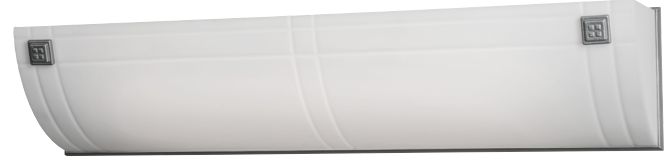

NT finish

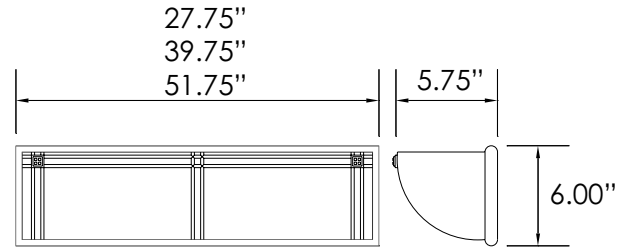

DAMP

ORDERING INFORMATION

5450 -

Model 2. 3. 4. 5. 6. (if required)

2. SIZE

26 L: 27.75"
38 L: 39.75"
50 L: 51.75"

3. FINISH

STANDARD
NT Nickel Tone

STANDARD
BL Black
BZ Bronze
GM Gun Metal
MB Metallic Bronze
PL Platinum
WH White

CUSTOM
Provide color sample or RAL code to match

4. WATTAGE

26 SIZE
H16 16W H Series LED
38 SIZE
H25 25W H Series LED
50 SIZE
H32 32W H Series LED

5. COLOR TEMPERATURE

35K 3500K standard color temperature
30K 3000K color temperature
40K 4000K color temperature

6. AVAILABLE OPTIONS

90R⁰ 90 CRI (3000K only)
BAC¹ Buy American Compliant
BBI^{2*} Integral Battery Backup (H25 & H32 only)
DTR⁴ Triac (Line Voltage) Dimming (120V)
ES⁶ ENERGY STAR® (Not available in 90 CRI)
FCL⁷ French Canadian Labels

Notes: (0) **90R** - cannot be combined with ES or T24 (1) **BAC** - cannot be combined with FCL (2) **BBI/BBS/BBC** - cannot be combined with DTR, ECW, EXT, or T24 (3) **BLD** - cannot be combined with DTR, OCC, or T24 (4) **DTR** - cannot be combined with BBI, BBC, BBS, BLD or T24 (5) **ECW** - cannot be combined with BBI, BBC, or DTR (6) **ES** - cannot be combined with 90R, FCL, or T24 (7) **FCL** - cannot be combined with BAC, ES, or T24 (8) **OCC** - cannot be combined with BLD (9) **T24** - cannot be combined with 90R, BBI, BBC, BBS, BLD, DTR, ES, or FCL (10) **BBS** - cannot be combined with BLD, DTR, ECW, EXT, OCC, or T24 (11) **PCH/PC4** - cannot be combined with BLD or OCC

Add'l Notes: ***BBI/BBS/BBC** - standard BBI (and BBS) option has a minimum operating temperature of 10C/50F. BBC option has a minimum operating temperature of -20C/-4F. ****BLD** - Bi-Level Dimming is field adjustable from 100% to a dimmed light level of 10, 20, 30, or 50%. All units are factory set at 50%.

Specifications and dimensions subject to change without notice.

Consult your Brownlee Lighting representative for availability and ordering information.