

1542

STANDARD SPECIFICATIONS

TRIM

Cold rolled steel, roll formed and assembled with welds, and bolted to the pan. The 0.125" thick bars provide a sturdy seat for the glass diffuser.

DIFFUSER

Formed glass, with a white finished interior and an etched outer surface softens the light. The diffuser simply slides into position.

PAN

Die formed, cold rolled steel design. The pan has white glass covers at each end.

ELECTRICAL

Quad CFL, 4-pin G24q Base 2700K lamp – 120-277V Electronic HPF Ballast

Fluorescent fixtures utilizing an occupancy sensor should include a programmed start HPF ballast. Fluorescent lamps powered by instant start or rapid start ballasts, or GU24 base compact fluorescent lamps used in this application may result in severely shortened lamp life and/or ballast damage.

MOUNTING

Directly to j-box (by others). Mounting hardware included.

FINISH

The 1542 series is finished in nickel tone as a standard offering. Options include all Brownlee paint finishes.

PROJECT:
MODEL #:
FIXTURE TYPE:



NT finish

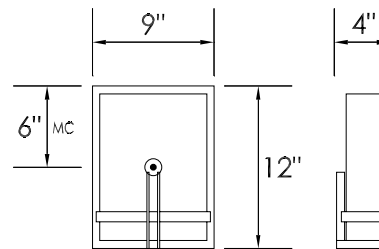

DAMP



ORDERING INFORMATION

1542 - - - -
 Model 2. 3. 4. (if required)

2. FINISH

STANDARD
NT Nickel Tone

OPTIONAL

BL Black
BZ Bronze
GM Gun Metal
MB Metallic Bronze
MG Metallic Gold
PL Platinum
WH White

CUSTOM

Provide color sample or RAL code to match

3. WATTAGE

13Q 1-13W Quad CFL, elec. HPF
18Q 1-18W Quad CFL, elec. HPF
26Q 1-26W Quad CFL, elec. HPF

4. AVAILABLE OPTIONS

BAC Buy American Compliant
DIM1 Dimming Ballast (120V)
DIM2 Dimming Ballast (277V)
ES ENERGY STAR® (26Q only)

ACCESSORIES (field installed)

BBR¹ Remote Battery Backup

1) BBI & BBR options have an operating temperature of +32°F to +122°F. BBIC & BBRC options have an operating temperature of -4°F to +131°F. BBR & BBRC are field installed options available on all HPF fluorescent (CFL & T8) fixtures, except those with dimming ballasts. The maximum distance between the battery and the fixture is 10' for HPF ballasts.

Specifications and dimensions subject to change without notice.

Consult your Brownlee Lighting representative for availability and ordering information.