

CRESCENT

STANDARD SPECIFICATIONS

TRIM

Cold rolled 16 GA steel, roll formed and welded assembly. The trim is bolted to the pan during final assembly.

DIFFUSER

Translucent, UV stabilized, white acrylic. Diffuser is formed over an aluminum die and maintains a .08" thickness throughout.

PAN

Cold rolled 20 GA steel, formed with die punch tooling.

LED PERFORMANCE - 3500K STANDARD

120-277V - 3500K, 82 CRI - L80 rating - 60,000 hrs - L70 rating (projected) - 100,000 hrs
Amperage rated @ 110V input
Operating ambient temperature: -20°C / -4°F - 40°C / 104°F

Delivered 3500K lumens noted. Consult Brownlee.com for performance of all CCTs.

B06 - 6W nominal, .05 A input - 438 lm. Non-dimming.
B12 - 12W nominal, .10 A input - 866 lm. Dimmable (0-10V).
C09 - 9W nominal, .10 A input - 611 lm. Dimmable (0-10V).

MOUNTING

Directly to j-box (by others). Mounting hardware included.

FINISH

The standard finish is a sturdy electroplated brushed nickel. Options include all Brownlee paint finishes. Plated finishes such as Brushed Nickel are suitable for indoor applications only. Installation outdoors voids the Brownlee Limited Warranty.

WARRANTY

5 year limited warranty on this LED product. Consult factory for details.

ORDERING INFORMATION

1468 - _____ - _____ - _____ - _____ - _____
Model 2. 3. 4. 5. (if required)

2. FINISH

STANDARD

BN Brushed Nickel

OPTIONAL

BL Black
BZ Bronze
GM Gun Metal
MB Metallic Bronze
MG Metallic Gold
NT Nickel Tone
PL Platinum
WH White

CUSTOM

Provide color sample or RAL code to match

3. WATTAGE

B06 6W B Series LED
B12 12W B Series LED
C09 9W C Series LED

4. COLOR TEMPERATURE

35K 3500K standard color temperature
27K 2700K color temperature
30K 3000K color temperature
40K 4000K color temperature

5. AVAILABLE OPTIONS

90R⁰ 90 CRI (3000K only)
BAC¹ Buy American Compliant
DTR⁴ Triac (Line Voltage) Dimming (120V)(All except B06)
ES⁶ ENERGY STAR® (Not available in 90 CRI)
FCL⁷ French Canadian Labels
T24⁹ Title 24 Compliant (B12 in 3000K only)

PROJECT:
MODEL #:
FIXTURE TYPE:



BN finish

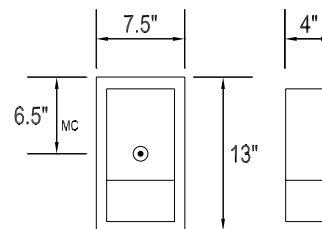

DAMP



Notes: (0) 90R - cannot be combined with ES or T24 (1) BAC - cannot be combined with FCL (2) BBI/BBS/BBC - cannot be combined with DTR, ECW, EXT, or T24 (3) BLD - cannot be combined with DTR, OCC, or T24 (4) DTR - cannot be combined with BBI, BBC, BBS, BLD or T24 (5) ECW - cannot be combined with BBI, BBC, or DTR (6) ES - cannot be combined with 90R, FCL, or T24 (7) FCL - cannot be combined with BAC, ES, or T24 (8) OCC - cannot be combined with BLD (9) T24 - cannot be combined with 90R, BBI, BBC, BBS, BLD, DTR, ES, or FCL (10) BBS - cannot be combined with BLD, DTR, ECW, EXT, OCC, or T24 (11) PCH/PC4 - cannot be combined with BLD or OCC

Add'l Notes: *BBI/BBS/BBC - standard BBI (and BBS) option has a minimum operating temperature of 10C/50F. BBC option has a minimum operating temperature of -20C/-4F. **BLD - Bi-Level Dimming is field adjustable from 100% to a dimmed light level of 10, 20, 30, or 50%. All units are factory set at 50%.

Specifications and dimensions subject to change without notice.

Consult your Brownlee Lighting representative for availability and ordering information.

