



Nickel Tone (NT) finish

2456 LED

The 2456 LED close-to-ceiling pendant pairs nicely with the 2656 LED traditional pendant and the two models are often used in the same space. This series offers a balance between traditional and contemporary, making it perfect for a variety of spaces from lobbies and entryways to foyers and corridors in applications such as libraries, schools, hotels and more. This unit provides a generous amount of indirect uplight in addition to downlight.

FINISHES



SALEM

STANDARD SPECIFICATIONS

BOWL

Smooth UV stabilized white acrylic. The 30" bowl is formed from 0.188" material.

TRIM

The trim consists of a spun aluminum trim ring, a formed, cold rolled steel ceiling canopy, stainless steel aircraft cables, and a steel stem.

HOUSING

Formed, cold rolled steel design, finished in a high reflectance powder coat white.

LED PERFORMANCE - 3500K STANDARD

120-277V - 3500K, 82 CRI - L80 rating - 60,000 hrs - L70 rating (projected) - 100,000 hrs

Amperage rated @ 110V input

Operating ambient temperature: -20°C / -4°F - 40°C / 104°F

Delivered 3500K lumens noted. Consult Brownlee.com for performance of all CCTs.

C37 - 35W nominal, .30 A input - 4460 lm. Dimmable (0-10V).

C49 - 45W nominal, .40 A input - 5916 lm. Dimmable (0-10V).

MOUNTING

Directly to j-box (by others). Mounting hardware included.

FINISH

The 2456 series is available in all Brownlee paint finishes as a standard offering.

WARRANTY

5 year limited warranty on this LED product. Consult factory for details.



NT finish

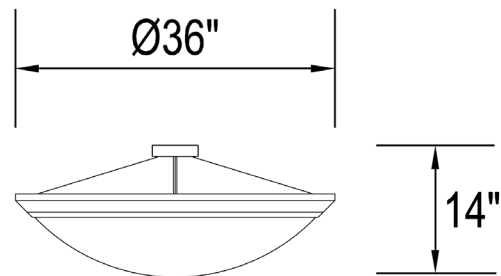

DAMP



ORDERING INFORMATION

2456 - - - - -
Model 2. 3. 4. 5.

2. FINISH

STANDARD

BL Black
BZ Bronze
GM Gun Metal
MB Metallic Bronze
MG Metallic Gold
NT Nickel Tone
PL Platinum
WH White

CUSTOM

Provide color sample or
RAL code to match

3. WATTAGE

C37 35W C Series LED
C49 45W C Series LED

4. COLOR TEMPERATURE

35K 3500K standard color temperature
27K 2700K color temperature
30K 3000K color temperature
40K 4000K color temperature

5. AVAILABLE OPTIONS

90R⁹ 90 CRI (3000K only)
BAC¹ Buy American Compliant
BLD³ Bi-Level Dimming
DTR⁴ Triac (Line Voltage) Dimming (120V)
ES⁶ ENERGY STAR[®] (Not available in 90 CRI)
FCL⁷ French Canadian Labels
OCC⁸ Occupancy Sensor
T24⁹ Title 24 JA8 Compliant (C49 in 3000K only)

Notes: (0) 90R - cannot be combined with ES. (1) BAC - cannot be combined with FCL. (2) BBI/BBS/BBC - cannot be combined with ECW, EXT, or T24.
(3) BLD - includes integral OCC sensor (do not combine with OCC option). Cannot be combined with DTR or T24. (4) DTR - cannot be combined with BLD or T24.
(5) ECW - cannot be combined with BBI, BBC, or DTR. (6) ES - cannot be combined with 90R or T24. (7) FCL - cannot be combined with BAC or T24.
(8) OCC - integral ON/OFF occupancy sensor. (9) T24 - includes JA8 labeling and 90 CRI LEDs (do not combine with 90R option). Cannot be combined with BBI, BBC, BBS, BLD, DTR, ES, or FCL. (10) BBS - cannot be combined with BLD, ECW, EXT, OCC, or T24. (11) PCH/PC4 - cannot be combined with BLD or OCC.
Add'l Notes: *BBI/BBS/BBC - standard BBI (and BBS) option has a minimum operating temperature of 10C/50F. BBC option has a minimum operating temperature of -20C/-4F. **BLD - integral OCC sensor with onboard control. 1: Motion is detected, illuminate to 100%. 2: Motion no longer detected, dim to 50% (factory default), 30%, 20% or 10%. 3: Remain in continuous dimmed state (factory default) or turn off after set period.

Specifications and dimensions subject to change without notice.

Consult your Brownlee Lighting representative for availability and ordering information.

BROWNLEE
LIGHTING
www.brownlee.com

REVISED
2020.12.23