

7039 LED



27K/30K ONLY

STANDARD SPECIFICATIONS

HOUSING

The large sized Dark Sky cutoff wall pack design features a die-cast aluminum housing. The hinged door is fastened over the continuous rubber seal with stainless steel hardware.

REFLECTOR

Formed aluminum, secured in position with hardware.

LENS

Clear, tempered glass is held into the cast door with stainless steel brackets and a sturdy, rubber gasket.

LED PERFORMANCE - 3500K STANDARD

120-277V - 3500K, 82 CRI - L80 rating - 60,000 hrs - L70 rating (projected) - 100,000 hrs
Amperage rated @ 110V input
Operating ambient temperature: -20°C / -4°F - 40°C / 104°F

Delivered 3500K lumens noted. Consult Brownlee.com for performance of all CCTs.

C37 - 35W nominal, .30 A input - 5017 lm. Dimmable (0-10V).

C49 - 45W nominal, .40 A input - 6761 lm. Dimmable (0-10V).

D30 - 30W nominal, .28 A input - 3070 lm. Non-dimming.

D56 - 56W nominal, .80 A input - 6135 lm. Non-dimming.

MOUNTING

The 7039 is designed to be mounted directly to the surface, and wired with rear conduit entry, or surface conduit into the side entry ports.

FINISH

This series is available in a standard bronze polyester powder coat.

WARRANTY

5 year limited warranty on this LED product. Consult factory for details.

PROJECT:
MODEL #:
FIXTURE TYPE:

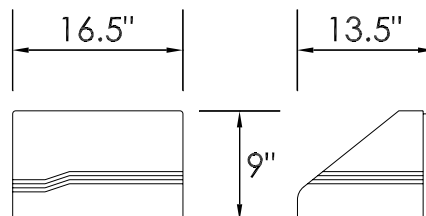

ORDERING INFORMATION



WET



7039

Model 2. 3. 4. (if required)

2. WATTAGE

C37 35W C Series LED

C49 45W C Series LED

D30 30W D Series LED

D56 56W D Series LED

3. COLOR TEMPERATURE

35K 3500K standard color temperature

27K 2700K color temperature (C Series only)

30K 3000K color temperature (C Series only)

40K 4000K color temperature (C Series only)

4. AVAILABLE OPTIONS

BAC¹ Buy American Compliant

BBC Integral Battery Backup, Cold Weather (C Series only)

DTR⁴ Triac (Line Voltage) Dimming (120V) (C Series only)

ECW⁵ Extreme Cold Weather (-40°C / -40°F min.)

ES⁶ ENERGY STAR® (C Series only)

FCL⁷ French Canadian Labels

PO1 Photo Control (120V)

PO2 Photo Control (208, 240, 277V)

T24⁹ Title 24 Compliant (C49 in 3000K only)

Notes: (0) 90R - cannot be combined with ES or T24 (1) BAC - cannot be combined with FCL (2) BBI/BBS/BBC - cannot be combined with DTR, ECW, EXT, or T24 (3) BLD - cannot be combined with DTR, OCC, or T24 (4) DTR - cannot be combined with BBI, BBC, BBS, BLD or T24 (5) ECW - cannot be combined with BBI, BBC, or DTR (6) ES - cannot be combined with 90R, FCL, or T24 (7) FCL - cannot be combined with BAC, ES, or T24 (8) OCC - cannot be combined with BLD (9) T24 - cannot be combined with 90R, BBI, BBC, BBS, BLD, DTR, ES, or FCL (10) BBS - cannot be combined with BLD, DTR, ECW, EXT, OCC, or T24 (11) PCH/PC4 - cannot be combined with BLD or OCC

Add'l Notes: *BBI/BBS/BBC - standard BBI (and BBS) option has a minimum operating temperature of 10C/50F. BBC option has a minimum operating temperature of -20C/-4F. **BLD - Bi-Level Dimming is field adjustable from 100% to a dimmed light level of 10, 20, 30, or 50%. All units are factory set at 50%.

Specifications and dimensions subject to change without notice.

Consult your Brownlee Lighting representative for availability and ordering information.



REVISED
2020.04.22