

5060 LED

STANDARD SPECIFICATIONS

HOUSING

Cold rolled steel, die-formed and assembled with hardware and welds, and can be mounted horizontally or vertically. The end caps and the front baffle are die-formed, and secure the diffuser to the housing with nuts.

DIFFUSER

Translucent UV stabilized clear prismatic acrylic. The extruded diffuser slips into a designed track to ensure it stays in position, and the material can withstand minor impact without breaking.

LED PERFORMANCE - 3500K STANDARD

120-277V - 3500K, 82 CRI - L80 rating - 60,000 hrs - L70 rating (projected) - 100,000 hrs
Amperage rated @ 110V input
Operating ambient temperature: -20°C / -4°F - 40°C / 104°F

Standard 3500K source lumens noted. Consult Brownlee.com for performance of all CCTs.
H32 - 32W nominal, .26 A input - 4119 lm - 130 lm/W. Dimmable (0-10V).
H63 - 63W nominal, .53 A input - 8056 lm - 130 lm/W. Dimmable (0-10V).

MOUNTING

Fixture uses wall anchors (by others) appropriate for the mounting surface.

FINISH

The 5060 series housing is finished in a plated white finish. The finish for this series is suitable for indoor applications only. Installation outdoors voids the Brownlee Limited Warranty.

WARRANTY

5 year limited warranty on this LED product. Consult factory for details.

PROJECT:

MODEL #:

FIXTURE TYPE:

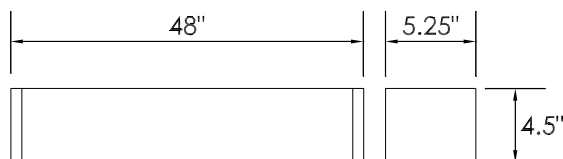

DAMP

ORDERING INFORMATION

5060

Model

2.

3.

4. (if required)

2. WATTAGE

H32 32W H Series LED (uplight & downlight)
H63 63W H Series LED (uplight & downlight)

3. COLOR TEMPERATURE

35K 3500K standard color temperature
30K 3000K color temperature
40K 4000K color temperature

4. AVAILABLE OPTIONS

90R⁰ 90 CRI (3000K only)
2CT Dual Independent Circuits (H63 only)
BAC¹ Buy American Compliant
BBI^{2*} Integral Battery Backup (H32 only)
DTR⁴ Triac (Line Voltage) Dimming (120V)
ES⁶ ENERGY STAR[®] (H32 only) (Not available in 90 CRI)
PCH¹¹ Pull Chain: On, Off (120V)
PC4¹¹ 4 Position Pull Chain: Uplight & Downlight, Uplight Only, Downlight Only, Off (H63 only) (120V)
FCL⁷ French Canadian Labels

Note: For separate control of the uplight and downlight components, please specify H63 and 2CT.

Notes: (0) **90R** - cannot be combined with ES or T24 (1) **BAC** - cannot be combined with FCL (2) **BBI/BBS/BBC** - cannot be combined with DTR, ECW, EXT, or T24 (3) **BLD** - cannot be combined with DTR, OCC, or T24 (4) **DTR** - cannot be combined with BBI, BBC, BBS, BLD or T24 (5) **ECW** - cannot be combined with BBI, BBC, or DTR (6) **ES** - cannot be combined with 90R, DTR, FCL, or T24 (7) **FCL** - cannot be combined with BAC, ES, or T24 (8) **OCC** - cannot be combined with BLD (9) **T24** - cannot be combined with 90R, BBI, BBC, BBS, BLD, DTR, ES, or FCL (10) **BBS** - cannot be combined with BLD, DTR, ECW, EXT, OCC, or T24 (11) **PCH/PC4** cannot be combined with BLD or OCC

Add'l Notes: ***BBI/BBS/BBC** - standard BBI (and BBS) option has a minimum operating temperature of 10C/50F. BBC option has a minimum operating temperature of -20C/-4F. ****BLD** - Bi-Level Dimming is field adjustable from 100% to a dimmed light level of 10, 20, 30, or 50%. All units are factory set at 50%.

Specifications and dimensions subject to change without notice.

Consult your Brownlee Lighting representative for availability and ordering information.