

2326

STANDARD SPECIFICATIONS

PAN

Cold rolled 22 GA steel, formed in a die, finished in a powder coat high reflectance white paint. The pan features weld nuts for a "twist and hold" installation of the diffuser.

DIFFUSER

The drum features a high quality UV stabilized white acrylic outer shell. The base (bottom) of the drum features an inset section and is constructed with high transmission white acrylic. The fixture can be cleaned with a damp cloth and mild detergent if needed.

ELECTRICAL

Quad CFL, 4-pin G24q Base 2700K lamp – 120-277V Electronic HPF Ballast
 GU24 CFL, 2-prong Base 2700K lamp – 120V Electronic NPF Ballast
 Circline, G10Q Base 4000K lamp – 120V Electronic NPF Ballast

Brownlee Lighting does not recommend GU24 base lamps for 24 hour operation due to lamp manufacturer specifications.

Fluorescent fixtures utilizing an occupancy sensor should include a programmed start HPF ballast. Fluorescent lamps powered by instant start or rapid start ballasts, or GU24 base compact fluorescent lamps used in this application may result in severely shortened lamp life and/or ballast damage.

MOUNTING

Directly to j-box (by others). Mounting hardware included.

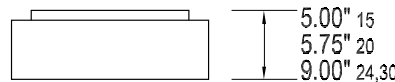
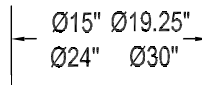

WBK diffuser

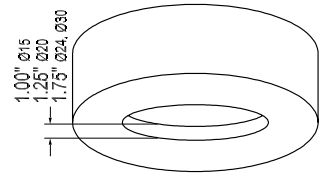

BBI OPTION

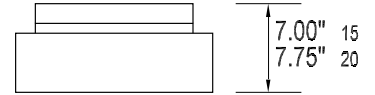

DAMP



ORDERING INFORMATION

2326

Model 2. 3. 4. 5. (if required)

2. SIZE

15 15" dia.
 20 19.25" dia.
 24 24" dia.
 30 30" dia.

3. WATTAGE

15 SIZE

213Q 2-13W Quad CFL, elec. HPF
313Q 3-13W Quad CFL, elec. HPF
18Q 1-18W Quad CFL, elec. HPF
218Q 2-18W Quad CFL, elec. HPF
26Q 1-26W Quad CFL, elec. HPF
226Q 2-26W Quad CFL, elec. HPF

213G 2-13W GU24 CFL, elec. NPF
313G 3-13W GU24 CFL, elec. NPF
18G 1-18W GU24 CFL, elec. NPF
218G 2-18W GU24 CFL, elec. NPF

22C 1-22W Circline, elec. NPF
32C 1-32W Circline, elec. NPF
54C 1-32W & 1-22W Circline, elec. NPF

20 SIZE

413Q 4-13W Quad CFL, elec. HPF
318Q 3-18W Quad CFL, elec. HPF

20 SIZE CONT'D

226Q 2-26W Quad CFL, elec. HPF
326Q 3-26W Quad CFL, elec. HPF

413G 4-13W GU24 CFL, elec. NPF
318G 3-18W GU24 CFL, elec. NPF

24 & 30 SIZE

413Q 4-13W Quad CFL, elec. HPF
418Q 4-18W Quad CFL, elec. HPF
326Q 3-26W Quad CFL, elec. HPF
426Q 4-26W Quad CFL, elec. HPF

332T 3-32W Triple CFL, elec. HPF
432T 4-32W Triple CFL, elec. HPF

4. DIFFUSER

WA White Acrylic
WBK Woven Black

5. AVAILABLE OPTIONS

BAC Buy American Compliant
BBI¹ Integral Battery Backup (Q only, adds 2" to depth)
DIM1 Dimming Ballast (120V) (Q only)
DIM2 Dimming Ballast (277V) (Q only)
ES ENERGY STAR® (26Q, 226Q, 326Q & 426Q only)

1) BBI & BBR options have an operating temperature of +32°F to +122°F. BBIC & BBRC options have an operating temperature of -4°F to +131°F. BBR & BBRC are field installed options available on all HPF fluorescent (CFL & T8) fixtures, except those with dimming ballasts. The maximum distance between the battery and the fixture is 10' for HPF ballasts.

Specifications and dimensions subject to change without notice.

Consult your Brownlee Lighting representative for availability and ordering information.