

# 1468 LED

## STANDARD SPECIFICATIONS

### TRIM

Cold rolled 16 GA steel, roll formed and welded assembly. The trim is bolted to the pan during final assembly.

### DIFFUSER

Translucent, UV stabilized, white acrylic. Diffuser is formed over an aluminum die and maintains a .08" thickness throughout.

### PAN

Cold rolled 20 GA steel, formed with die punch tooling.

### LED PERFORMANCE - 3500K STANDARD

120-277V - 3500K, 82 CRI - L80 rating - 60,000 hrs - L70 rating (projected) - 100,000 hrs  
Amperage rated @ 110V input  
Operating ambient temperature: -20°C / -4°F - 40°C / 104°F

Delivered 3500K lumens noted. Consult Brownlee.com for performance of all CCTs.

B06 - 6W nominal, .05 A input - 438 lm. Non-dimming.

B12 - 12W nominal, .10 A input - 866 lm. Dimmable (0-10V).

C09 - 9W nominal, .10 A input - 611 lm. Dimmable (0-10V).

### MOUNTING

Directly to j-box (by others). Mounting hardware included.

### FINISH

The standard finish is a sturdy electroplated brushed nickel. Options include all Brownlee paint finishes. Plated finishes such as Brushed Nickel are suitable for indoor applications only. Installation outdoors voids the Brownlee Limited Warranty.

### WARRANTY

5 year limited warranty on this LED product. Consult factory for details.

### ORDERING INFORMATION

PROJECT:
MODEL #:
FIXTURE TYPE:



BN finish

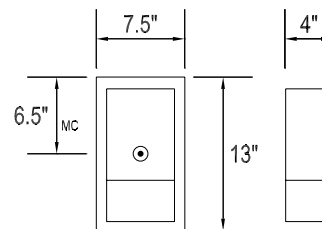

DAMP



**1468** - \_\_\_\_\_ - \_\_\_\_\_ - \_\_\_\_\_ - \_\_\_\_\_ - \_\_\_\_\_  
Model                      2.                      3.                      4.                      5. (if required)

#### 2. FINISH

##### STANDARD

**BN**      Brushed Nickel

##### OPTIONAL

**BL**      Black  
**BZ**      Bronze  
**GM**      Gun Metal  
**MB**      Metallic Bronze  
**MG**      Metallic Gold  
**NT**      Nickel Tone  
**PL**      Platinum  
**WH**      White

##### CUSTOM

Provide color sample or RAL code to match

#### 3. WATTAGE

**B06**      6W B Series LED  
**B12**      12W B Series LED  
**C09**      9W C Series LED

#### 4. COLOR TEMPERATURE

**35K**      3500K standard color temperature  
**27K**      2700K color temperature  
**30K**      3000K color temperature  
**40K**      4000K color temperature

#### 5. AVAILABLE OPTIONS

**90R<sup>0</sup>**      90 CRI (3000K only)  
**BAC<sup>1</sup>**      Buy American Compliant  
**DTR<sup>4</sup>**      Triac (Line Voltage) Dimming (120V)(All except B06)  
**ES<sup>6</sup>**      ENERGY STAR® (Not available in 90 CRI)  
**FCL<sup>7</sup>**      French Canadian Labels  
**T24<sup>9</sup>**      Title 24 Compliant (B12 in 3000K only)

**Notes:** (0) **90R** - cannot be combined with ES or T24 (1) **BAC** - cannot be combined with FCL (2) **BBI/BBS/BBC** - cannot be combined with DTR, ECW, EXT, or T24 (3) **BLD** - cannot be combined with DTR, OCC, or T24 (4) **DTR** - cannot be combined with BBI, BBC, BBS, BLD or T24 (5) **ECW** - cannot be combined with BBI, BBC, or DTR (6) **ES** - cannot be combined with 90R, FCL, or T24 (7) **FCL** - cannot be combined with BAC, ES, or T24 (8) **OCC** - cannot be combined with BLD (9) **T24** - cannot be combined with 90R, BBI, BBC, BBS, BLD, DTR, ES, or FCL (10) **BBS** - cannot be combined with BLD, DTR, ECW, EXT, OCC, or T24 (11) **PCH/PC4** - cannot be combined with BLD or OCC

**Add'l Notes:** \***BBI/BBS/BBC** - standard BBI (and BBS) option has a minimum operating temperature of 10C/50F. BBC option has a minimum operating temperature of -20C/-4F. \*\***BLD** - Bi-Level Dimming is field adjustable from 100% to a dimmed light level of 10, 20, 30, or 50%. All units are factory set at 50%.

### Specifications and dimensions subject to change without notice.

Consult your Brownlee Lighting representative for availability and ordering information.

