

1325 LED

STANDARD SPECIFICATIONS

TRIM

1/4" Cold rolled steel, formed and mounted to the pan with formed steel brackets.

DIFFUSER

Translucent, UV stabilized 0.125" white acrylic formed over an aluminum die to maintain uniform thickness.

PAN

Cold rolled steel, formed with die punch tooling.

LED PERFORMANCE - 3500K STANDARD

120-277V - 3500K, 82 CRI - L80 rating - 60,000 hrs - L70 rating (projected) - 100,000 hrs
 Amperage rated @ 110V input
 Operating ambient temperature: -20°C / -4°F - 40°C / 104°F

Delivered 3500K lumens noted. Consult Brownlee.com for performance of all CCTs.

- B06 - 6W nominal, .05 A input - 586 lm. Non-dimming.
- B12 - 12W nominal, .10 A input - 1158 lm. Dimmable (0-10V).
- C09 - 9W nominal, .10 A input - 817 lm. Dimmable (0-10V).
- C17 - 16W nominal, .15 A input - 1674 lm. Dimmable (0-10V).
- C24 - 23W nominal, .20 A input - 2297 lm. Dimmable (0-10V).

MOUNTING

Directly to j-box (by others). Mounting hardware included.

FINISH

The 1325 series is available in all Brownlee paint finishes as a standard offering.

WARRANTY

5 year limited warranty on this LED product. Consult factory for details.

ORDERING INFORMATION

PROJECT:
MODEL #:
FIXTURE TYPE:



BZ finish

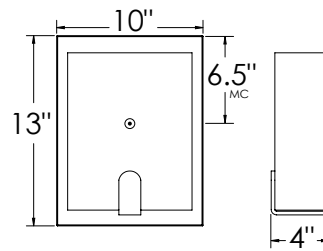

DAMP



1325 - Model - 2. - 3. - 4. - 5. (if required)

2. FINISH

STANDARD

- AB Antique Bronze
- AS Antique Silver
- BL Black
- BZ Bronze
- DB Desert Bronze
- GM Gun Metal
- MB Metallic Bronze
- MG Metallic Gold
- NT Nickel Tone
- PL Platinum
- WH White

CUSTOM

Provide color sample or RAL code to match

3. WATTAGE

- B06** 6W B Series LED
- B12** 12W B Series LED
- C09** 9W C Series LED
- C17** 16W C Series LED
- C24** 23W C Series LED

4. COLOR TEMPERATURE

- 35K** 3500K standard color temperature
- 27K** 2700K color temperature
- 30K** 3000K color temperature
- 40K** 4000K color temperature

5. AVAILABLE OPTIONS

- 90R⁰** 90 CRI (3000K only)
- BAC¹** Buy American Compliant
- DTR⁴** Triac (Line Voltage) Dimming (120V) (All except B06)
- ES⁶** ENERGY STAR® (Not available in 90 CRI)
- FCL⁷** French Canadian Labels
- T24⁹** Title 24 Compliant (B12 & C24 in 3000K only)
- TBC** Top/Bottom Covers (Perforated)

Notes: (0) **90R** - cannot be combined with ES or T24 (1) **BAC** - cannot be combined with FCL (2) **BBI/BBS/BBC** - cannot be combined with DTR, ECW, EXT, or T24 (3) **BLD** - cannot be combined with DTR, OCC, or T24 (4) **DTR** - cannot be combined with BBI, BBC, BBS, BLD or T24 (5) **ECW** - cannot be combined with BBI, BBC, or DTR (6) **ES** - cannot be combined with 90R, FCL, or T24 (7) **FCL** - cannot be combined with BAC, ES, or T24 (8) **OCC** - cannot be combined with BLD (9) **T24** - cannot be combined with 90R, BBI, BBC, BBS, BLD, DTR, ES, or FCL (10) **BBS** - cannot be combined with BLD, DTR, ECW, EXT, OCC, or T24 (11) **PCH/PC4** - cannot be combined with BLD or OCC

Add'l Notes: ***BBI/BBS/BBC** - standard BBI (and BBS) option has a minimum operating temperature of 10C/50F. BBC option has a minimum operating temperature of -20C/-4F. ****BLD** - Bi-Level Dimming is field adjustable from 100% to a dimmed light level of 10, 20, 30, or 50%. All units are factory set at 50%.

Specifications and dimensions subject to change without notice.

Consult your Brownlee Lighting representative for availability and ordering information.

